

PREPARING FOR THE
BIG SWITCH...



ON

The story so far...

In the summer of 2010 Veolia were awarded a contract to build and operate an Energy Recovery Facility (ERF) at the Four Ashes Industrial Estate.

We recognised the fact that planning permission had already been granted for an ERF at the site but we looked at ways to improve the original design of the ERF operationally, environmentally and in sustainability terms.

In August 2010 we submitted a revised Planning Application to Staffordshire County Council.



Our plans are based on Staffordshire's commitment to firstly reduce the amount of waste produced and to significantly increase recycling and composting rates.

In keeping with the County Council's original proposals, our facility is designed to process 300,000 tonnes of residual household waste every year which is not suitable for recycling or composting. The facility will produce 23MW of energy for the National Grid suitable for powering 32,000 homes.

The development of this facility at Four Ashes forms part of these important objectives and will recover energy from waste that would otherwise be sent to environmentally and financially costly landfill.



The revised planning application sought approval to:

- Reduce the overall footprint and size of the facility making it smaller
- Make the height of our building two metres lower than the initially consented proposals
- Redesign the roof to make it less prominent
- Reposition and reduce the diameter of the stack.

The building still has the benefit of a 'living roof' which means roof sections are planted with species to help the building blend into the surrounding area and to increase biodiversity.

The site will also be enhanced with extensive landscaping, sustainable drainage and habitat creation.

In February 2011 the revised application was granted planning permission.

One of the pre-commencement requirements of the planning permission was the upgrading of the A5/Vicarage Road junction which is now complete.

What is?



Project W2R = Waste to Resource. This is a partnership project comprising the development of a treatment solution for waste that will contribute to the delivery of sustainable waste management in the county.

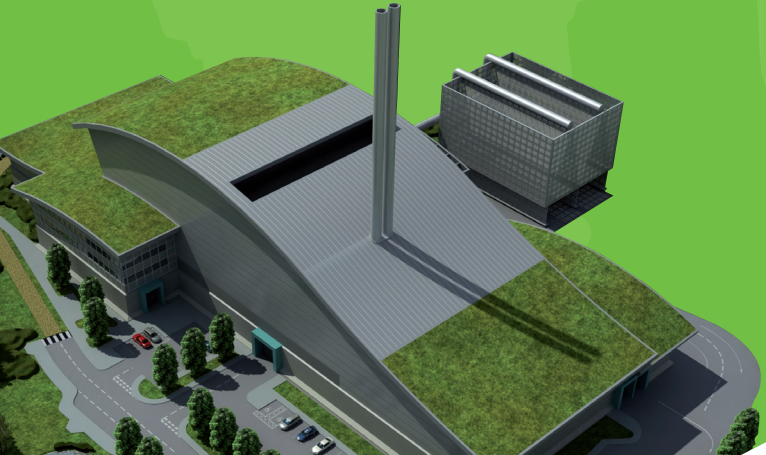

The next stage

Since gaining planning permission considerable work has been going on behind the scenes. Our main contractor Clugston has been formally appointed and together we have been completing the detailed design works and submissions to Staffordshire County Council to discharge pre-commencement planning conditions.

Veolia recognises the importance of working with the local community and to keep them informed and with the help of the Community Liaison Group we have set up this will be one of the ways we will be doing this.

Our Community Liaison Group provides a focus for liaison and feedback during the construction and eventual operation phases of the development. The group consists of local councillors members from the local community and local businesses.

Site Mobilisation

We are now moving to the stage where we will be commencing construction and this will be happening in June.

This will include:

- Mid June – Construction cabins will start arriving on site.

Civil engineering and ground work will start.

We will keep you informed with regular updates. But if you do have any queries please call our dedicated information number.

Get in touch

We have launched a web site that will be updated regularly and the minutes of the Community Liaison Group will appear on this site along with other useful information about the site.

www.veolia.co.uk/staffordshire

We have also appointed a dedicated Communications Manager, **Hilary Hampton**, who can be contacted on: **01902 794703**

Or you can email:
info.staffordshire@veolia.co.uk

